



L&T Realty

RAINTREE BOULEVARD

OLD WORLD CHARM. REDISCOVERED.





OLD WORLD CHARM. REDISCOVERED.

L&T Realty presents Raintree Boulevard – a premium lifestyle mixed-use township located in the serene locales of Hebbal, Bengaluru. Raintree Boulevard is an endeavour to preserve the environment while developing

a residential oasis, offering its residents the luxuries of fine-living along with the enchantment of being cradled in the pristine lap of nature.

Project Highlights:

- A mixed-use township spread over across 65 acres of pristine greens, that has been conceptualised based on urban green courts having two main boulevards lined by trees.
- The cluster will be developed around the central green landscape.
- Well-designed 2, 3, & 4 bedroom apartments in variants
- Safety, security & fire-fighting systems
- Traffic-free central zone





IT'S THE PLACE TO BE. TODAY AND TOMORROW.

Raintree Boulevard on Bellary Road has excellent connectivity to well-developed civic infrastructure such as 10+4 Lane Road (NH-7/AH43), which gives it close proximity to the CBD. It will offer faster connectivity through an expressway flyover planned from CBD to Hebbal, and is in close vicinity to the KIAL Airport.

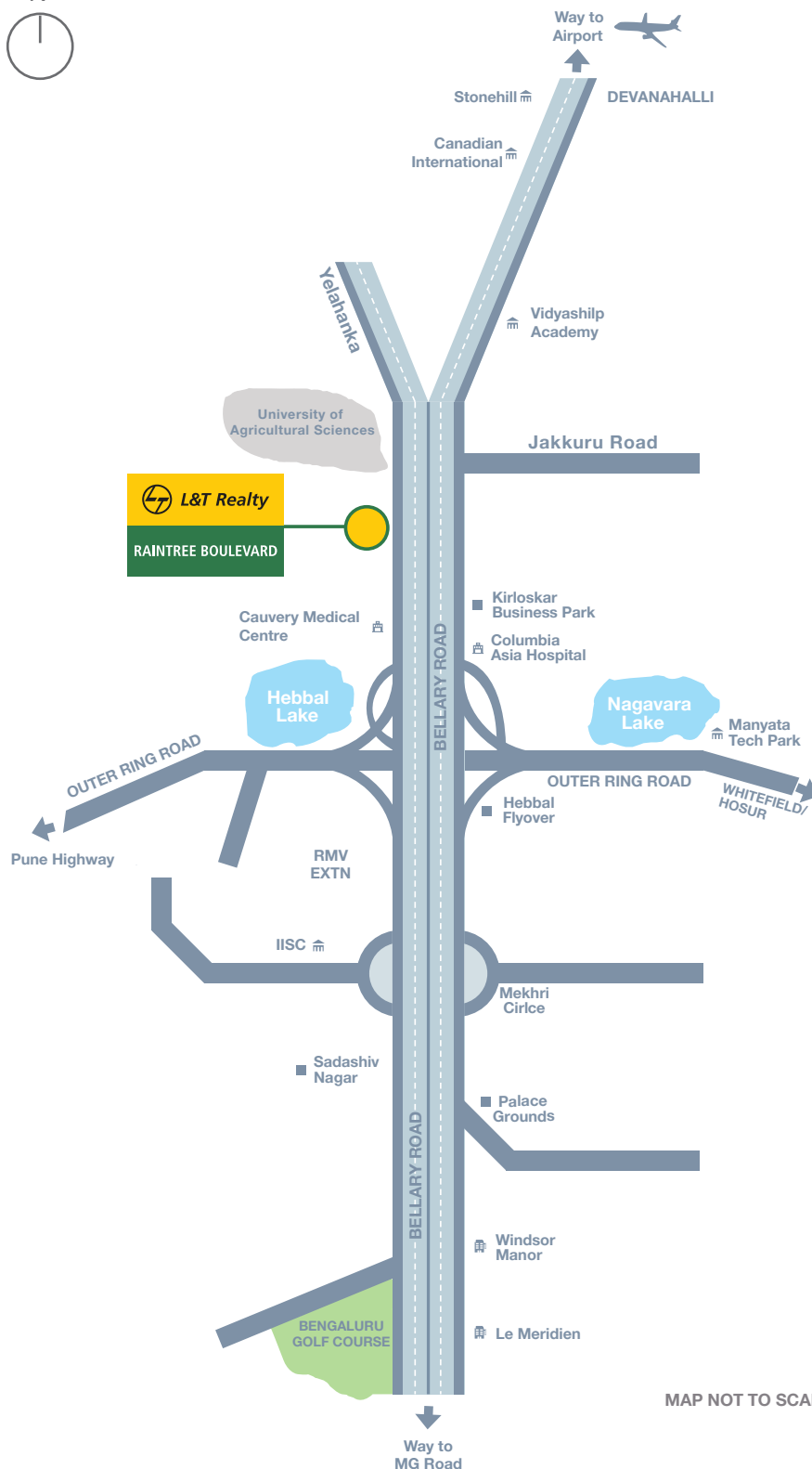

MAP NOT TO SCALE

Roads and Transport

- Sahakara Nagar - 2 Kms
- Hebbal Circle - 3 Kms
- Manyata Tech Park - 6.5 Kms
- City Railway Station - 11.7 Kms
- MG Road - 12 Kms
- KIAL Airport - 22 Kms

Schools

- Vidyashilp
- Presidency
- Mallya Aditi
- Canadian International
- Ryan International
- Vibgyor

Hospitals

- Columbia Asia
- Cauvery Medical
- Baptist Hospital
- Profile Hospital

Colleges

- BMS IT
- Presidency
- Sindhi
- Reva
- Aditya
- NITTE

Commercial

- Manyata Tech Park
- Sattva Galleria
- RMZ Latitude
- Brigade Magnum
- Brigade Opus
- NCC



BEAUTIFULLY CRAFTED HOMES

INSIDE THE APARTMENT

- Vitrified tiles in living, dining and additional bedrooms in the apartment.
- Laminated wooden flooring in the master bedroom.
- Enabling Split AC Provision in living/dining (one AC) & master bedroom.
- Matt-finished ceramic/ vitrified tiles for kitchen.
- Anti-skid ceramic/ vitrified tiles in bathrooms.
- Premium quality fittings and fixtures for the bathrooms.
- Anti-skid ceramic tiles in balconies and utility areas.





A VIBRANT URBAN DESTINATION

OUTDOOR:

- Luxurious landscaped gardens.
- Exclusive cycling and jogging tracks.
- Large multi-purpose amphitheatre.
- Senior citizens' area.
- Kid's play area.
- Large traffic-free podiums; safe walk/play zones for both the young and the aged.







BEAUTIFULLY CRAFTED TOWERS
OFFERING STUNNING VIEWS



SITE PLAN

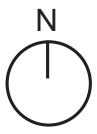

- 2BHK
- 3BHK
- 3BHK (L)
- 4BHK
- 4BHK (L)

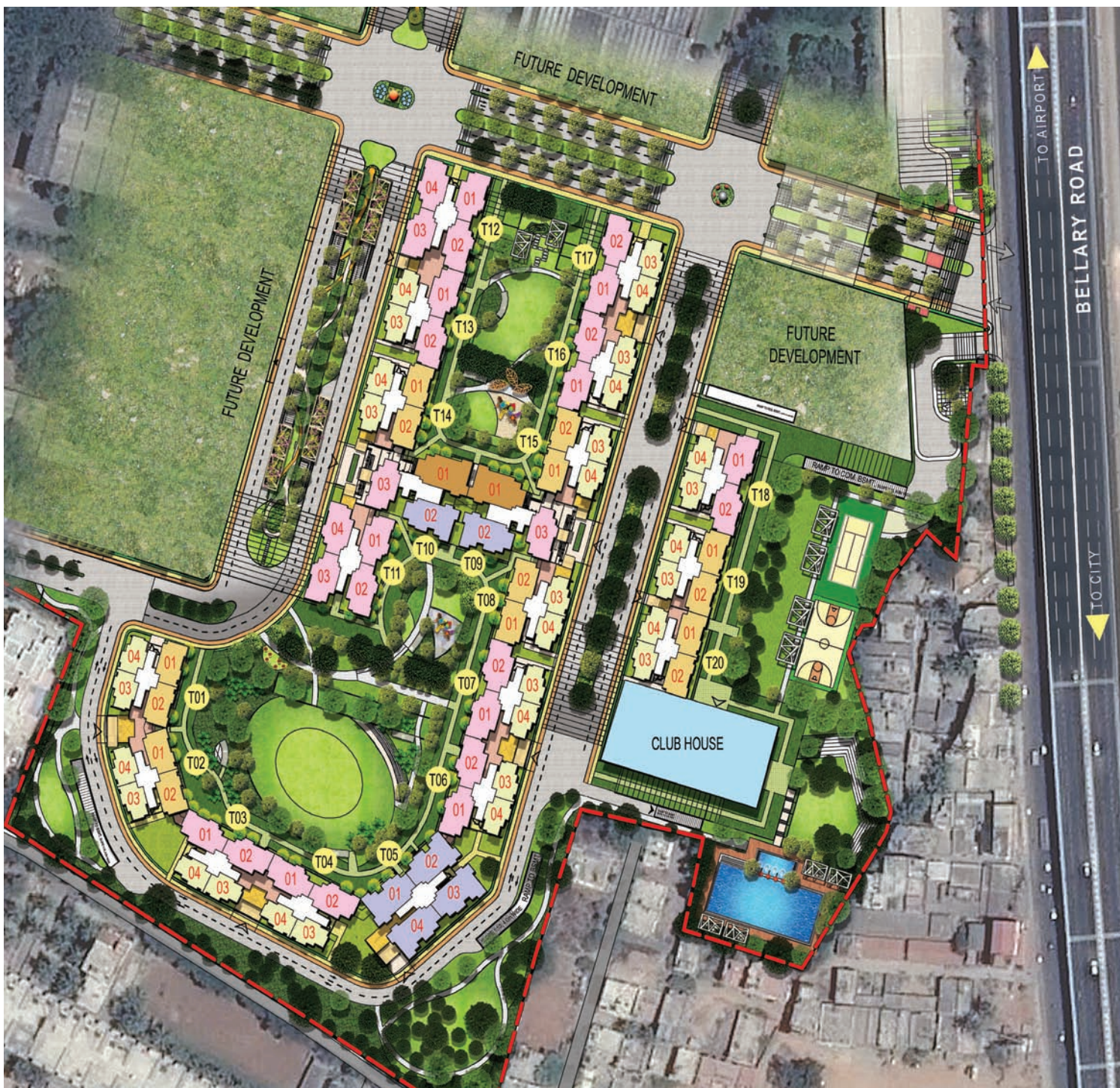

Crescent Bay, Parel, Mumbai



Seawoods Grand Central, Navi Mumbai
Commercial | Retail | Entertainment

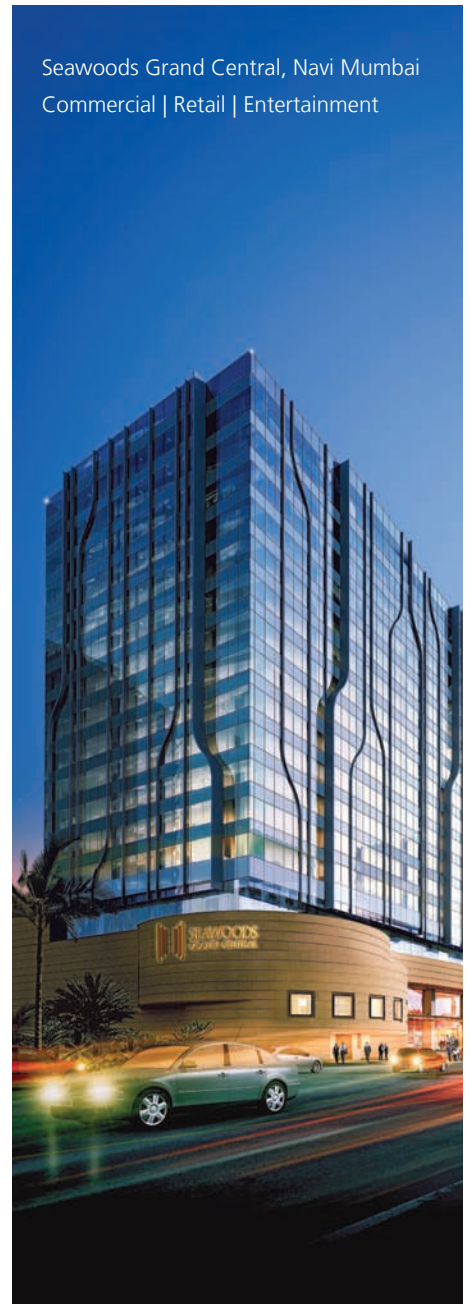

Emerald Isle, Powai, Mumbai

L&T REALTY - OUR PROJECTS:

Crescent Bay, Parel - A residential complex comprising six towers with 2, 3, and 4 BHK apartments, along with themed gardens, a modern clubhouse and an array of sports facilities.

Emerald Isle, Powai - A 16 acre gated community complex, Emerald Isle is nestled amidst beautiful green surroundings, right next to key business and entertainment destinations.

Eden Park, Chennai - A gated, integrated township that spreads across 90 acres and comprises apartments, reputed schools, healthcare and shopping facilities. With Phase I complete, the project is gearing up to launch Phase II, which spreads across 45 acres.

Seawoods Grand Central - Located at Navi Mumbai and within 10 kms of the proposed international airport as well as the Mumbai Trans-Harbour Link, this unique project is slated to be India's largest transit-oriented development. Spread over approximately 40 acres of land, this integrated development is planned with Grade A commercial, retail, leisure and entertainment spaces, built around a world-class railway station.

For more information, visit us at www.Lntrealty.com

MarinaScape, Dubai



HITEC City, Hyderabad

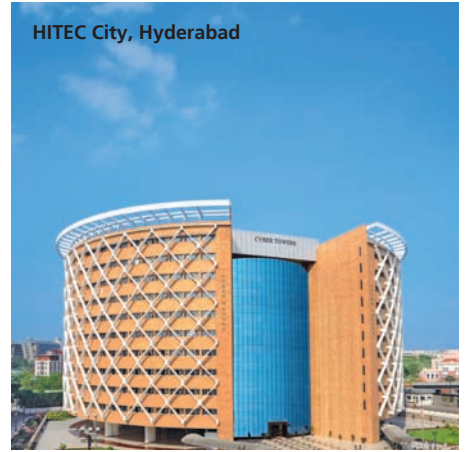

Bahai Temple, New Delhi



International Airport, T2, Mumbai

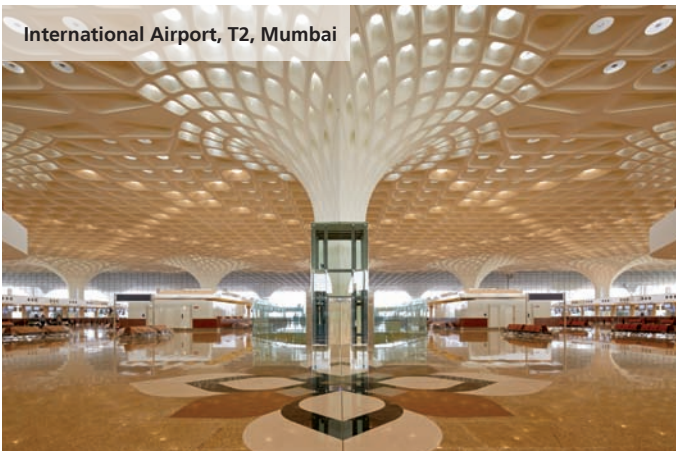

Wankhede Stadium, Mumbai



LARSEN & TOUBRO

Larsen & Toubro is a technology, engineering, construction, manufacturing and financial services conglomerate with global operations. It is ranked 4th in the global list of Green Companies in the industrial sector by the reputed international magazine Newsweek, and ranked the world's 9th Most Innovative Company by Forbes International. L&T is one of the largest and most respected companies in India's private sector.

Through its constant focus on innovation, L&T has managed to offer solutions of increasing complexity that help it acquire and retain a competitive edge. The company leverages its people, processes and philosophy to innovate, ideate and create more effective solutions for its large customer base across key sectors, such as infrastructure, oil & gas, petrochemicals, minerals, metallurgical, chemicals, fertilizers, power, mining and construction. A strong, customer-focused approach and a constant quest for top-class quality have enabled L&T to attain and sustain leadership in its major lines of business for over seven decades.



L&T Realty

RAINTREE BOULEVARD

OLD WORLD CHARM. REDISCOVERED.

L&T Realty, L&T Business Park
Gate No. 5, JVL R - Saki Vihar Road
Junction, Powai, Mumbai - 400072

Site Address: Raintree Boulevard
Bellary Road, Byatarayanapura,
Bengaluru, Karnataka - 560024

Toll free no: 1800 266 8383
Ltrbangalore@larsentoubro.com
www.Lntrealty.com

* Disclaimer: The floor plans, design, layouts, facilities, dimensions, specifications including the layout of the development undertaken for the project under reference are subject to change without prior notice. The presenter and the images are artistic impression for representations purposes only and are not indicative of the actual floor plans, designs and specifications. This does not constitute an offer and/or contract of any nature. The development undertaken is subject to the approval of the respective authorities. We reserve the rights to change and or modify all or any specifications without any notice or intimation.